

- ⚠ WARNING:** Never use solvents or other harsh chemicals for cleaning the non-metallic parts of the tool. These chemicals may weaken the plastic materials used in these parts. Use a cloth dampened only with water and mild soap. Never let any liquid get inside the tool; never immerse any part of the tool into a liquid.

Accessories

- ⚠ WARNING:** Since accessories, other than those offered by DeWALT, have not been tested with this product, use of such accessories with this tool could be hazardous. To reduce the risk of injury, only DeWALT recommended accessories should be used with this product.

Recommended accessories for use with your tool are available at extra cost from your local dealer or authorized service center. If you need assistance in locating any accessory, please contact DeWALT Industrial Tool Co., 701 East Joppa Road, Towson, MD 21286, call 1-800-4-DeWALT (1-800-433-9258) or visit our website: www.dewalt.com.

Replacement Accessories

- ⚠ WARNING:** To reduce the risk of serious personal injury, turn appliance off and remove battery before making any adjustments or removing/installing attachments or accessories.

- ⚠ WARNING:** Do not use any blades, or any accessory or attachment other than those recommended by DeWALT on this trimmer. Serious injury or product damage may result.

An extended coverage guard is available (sold separately) for extra coverage if desired. Use DeWALT replacement guard Part Number 90624357.

Use DeWALT replacement .080 inch and .095 inch lines.

- For optimal performance use .080 inch line. DeWALT .095 inch line can also be used, but may degrade runtime of the trimmer. Using any other line with the trimmer can degrade performance and/or cause damage to the trimmer.

Replacing the Cutting Line (Fig. A, J–M)

- ⚠ CAUTION:** To avoid appliance damage, if the cutting line protrudes beyond the trimming blade, cut it off so that it just reaches the blade.

- Remove battery.
- Turn spool **21** clockwise to unlock as shown in figure J. The white nub **22** (figure M) inside the spool will rotate away from the spool window **23** to indicate it is unlocked.

fig. J

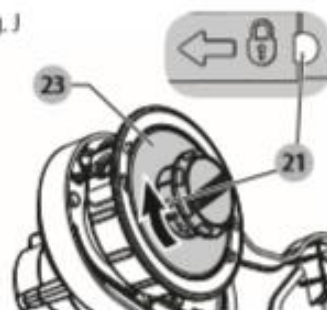

- Pull the spool straight out to remove.
- Remove any dirt and grass from the spool and housing.
- First, wind new line in the channel of the spool closest to the holding slots **24** as shown in figure K.
- Place the end of the cutting line **25** into the retaining hole **26**.

fig. K

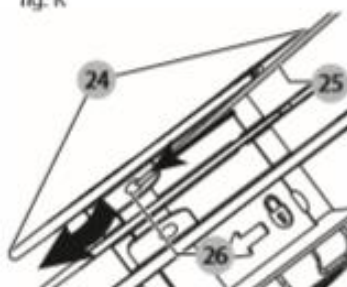

- Wind the cutting line onto the spool in the direction of the arrow on the bottom of the spool. Make sure to wind the line on neatly and in layers. Do not crisscross (figure L).
- When the wound cutting line reaches the beginning of the holding slots **24**, cut the line approximately 4 inches (106 mm).
- Push the line in the holding slots on one side of the spool to hold the first line while you wind the second line.
- Repeat the above procedure for the second cutting line on the lower section of the spool.

- ⚠ CAUTION:** Before you begin trimming, only use the appropriate type of cutting line. Ensure that cutting line is present in both sections of the spool as shown in figure L.

fig. L

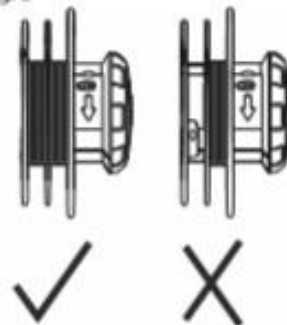

- Once both lines are wrapped around the spool **23**, place your thumb and finger on the holding slots to further secure the string and feed the end of each line through the two holes **27** on either side of the head in the spool housing **11** as shown in figure M.

ENGLISH

- Line up the white nubs **22** inside the spool housing with the recesses **28** of the spool. Align the holding slots **24** with the two holes **27** as close as possible.
- Push the spool into the spool housing and turn counterclockwise to lock the spool in place. Ensure the white nub **22** appears in the spool window **21**. Make sure the line doesn't unravel and wrap around the shaft below the spool.
- Pull both ends of the cutting line to release them from the holding slots. If the line extends past the cutting blade on the guard cut the line so it just reaches the blade.

fig. M

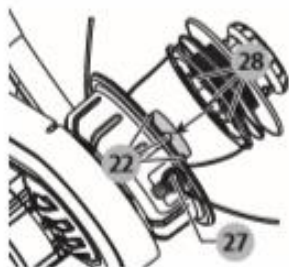

Replacing Spool Housing (Fig. N, O)

- Rotate the spool housing **11** until the hole **29** in the spindle **30** lines up with notch **31** in the guard **10**. A third hole in the motor housing **32** will be visible as shown in figure N. Insert screwdriver through each all three holes to prevent the spool housing from turning.
- Turn the spool housing clockwise as shown in figure O.
- Insert a screwdriver back through the three holes (**29**, **31**, and **32**) and thread the new spool housing counterclockwise and securely tighten onto the bolt **33** protruding from the trimmer.

fig. N

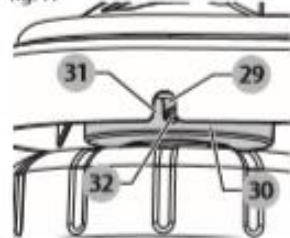

fig. O



Replacing Guard (Fig. P, Q)

⚠ WARNING: Never operate appliance without guard firmly in place. Damage or personal injury could result.

- Remove the spool housing as described in the "Replacing Spool Housing" section.
- Remove the 4 guard screws **34** shown in figure P.
- Lift the guard off at an angle as shown in figure Q.

fig. P

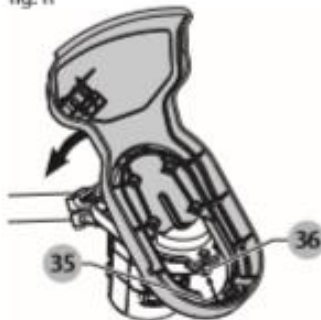

fig. Q



- To attached a new guard, slide the tab **35** of the new guard under the lip **36** of the motor housing **6**, then lower the back of the guard into place as shown in figure R.
- Replace and securely tighten the 4 guard screws **34**.
- Replace the spool housing as described in the "Replacing Spool Housing" section.

fig. R



Repairs

The charger and battery pack are not serviceable.

⚠ WARNING: To assure product SAFETY and RELIABILITY, repairs, maintenance and adjustment (including brush inspection and replacement) should be performed by a DeWALT factory service center or a DeWALT authorized service center. Always use identical replacement parts.

Register Online

Thank you for your purchase. Register your product now for:

- WARRANTY SERVICE:** Registering your product will help you obtain more efficient warranty service in case there is a problem with your product.
- CONFIRMATION OF OWNERSHIP:** In case of an insurance loss, such as fire, flood or theft, your registration of ownership will serve as your proof of purchase.
- FOR YOUR SAFETY:** Registering your product will allow us to contact you in the unlikely event a safety notification is required under the Federal Consumer Safety Act.